

## Packing Specification

Power Line Conditioner	1 set
Power cord	1 (only equipped on AV-250)
Manual	1 book
Warranty card	1 piece

## Scan & Surprise



WeChat Public No.



Official website

# UMIVC

a #6, Keyun Middle Road, A Zone, Shishan Industry Park, Nanhai, Foshan, Guangdong, China.  
C +86 757 8120 3017 [Hotline] e umivc@umipower.cn p 528225

MADE IN CHINA  
Manufacturer: UMI TECHNOLOGY CO., LTD

Please read this manual carefully before using the transformer, and keep it safely for future use.



# UMIVC

## ▼ Efficiency

designed with toroidal transformer, which owns the characteristics of low magnetic leakage, high efficiency, low loss and small volume. With high permeability oriented silicon steel made transformer core and 99.999% oxygen free copper (OFC) made enameled wire, which guarantee the superior performance, extremely low loss and up to above 95% efficiency of the toroidal transformer.

## ▼ Safety

- ▶ The transformer isolates the power completely from the city power supply, the secondary winding is not connected to the earth, there's no potential difference between any two lines and the earth. So, there will be no electric shock if someone touches any line, which ensures the electricity safety in household environment.
- ▶ Input voltage real-time monitoring, displays current voltage value accurately, intuitively and easily (Only equipped on AV-500 AV-1000).
- ▶ "Surge-Pro" : with soft start Circuit to avoid boot tripping (only equipped on AV - 500, AV -1000).
- ▶ Anti-seep soft-touch switch: an insulating oil paper is installed under the switch to prevent the water seeping into the inside to avoid the risk of leakage hazard (only equipped on AV - 500, AV -1000).
- ▶ Fuse tube equipped input circuit: when unexpected short circuit occurs in the transformer or output terminal, it will fusing and disconnect the input power immediately.
- ▶ Over-heating protection of the transformer: with equipped PTC sensor thermistor, the circuit breaker will be activated and disconnect the power supply, once the working temperature reaches 105°C.
- ▶ Fireproof: The toroidal transformer is wrapped with glass fiber bandage, which is with 850°C temperature-resistant.

## ▼ Filtering

- 1 High-quality toroidal transformer: the cores are with round edges, the windings are distributed and compact, which guarantee the low magnetic leakage and low interference.
- 2 Faraday electrostatic shielding and earth connecting is designed and put between the windings, which prevent the electrostatic interference and clutter crosstalk of the city power supply.
- 3 The toroidal transformer isolates the power utilization environment completely from the city power supply through electromagnetic coupling, eliminated various kinds of interference sources.
- 4 Due to the "low pass but high blocked" feature of the toroidal isolation transformer, the medium and high frequency harmonics in the city power supply and the clutter interference will be damaged or blocked by the transformer, while the low frequency signals like 50 Hz are completely passed, which helps to filter out the medium and high frequency clutter in city power supply.
- 5 As an inductor, the toroidal isolation transformer and filtering capacitance is designed as an effective filtering circuit to filter out harmful frequency signals and eliminate all EMI noise.

## ▼ Application

The product is widely applied in laser CD player, digital player, DAC, desktop amplifier, preamplifier audio, after-amplifier audio, combined amplifiers, TV, projector, set-top boxes, blue-ray DVD players, hard disk player, network storage, computer and other household appliances, and provides a clean power supply.



## ISOBOX AV SERIES

Power Line Conditioner AV Series

# AV-250 AV-500 AV-1000

- Safe . Save . Smart . Slim -

PRODUCT MANUAL

## Introduction

Thanks for your patronage and welcome to use UMIPower ISOBOX Power Line Conditioner AV series products.

The product is designed specifically for household AV, communication and computer products. The increasing power pollution, noise interference, impact current and voltage in the household power supply have been bringing substantial damage to household AV, communication and computer products, and also cause potential safety hazard to the users.

Therefore, for better performance of these household appliances, UMIPower specially designed an Isolation Power Line Conditioner: the ISOBOX - AV series products, which provide a safe and purified electric power environment for your household electrical appliances, protect the precious appliances from infringement.

ISOBOX-AV series of isolation power line conditioner, safe, simple, slim, and smart.

## Precaution

**Warning:**  
Pay attention to electrical safety when using this product, and following precautions should be noted at the same time!

**Danger:**  
To avoid electric shock, please DO NOT open the lid!

- The total power of the appliances should not exceed the rated power of the transformer.
- The transformer is designed for indoor use only.
- The transformer case is plastic, DO NOT use it in high temperature environment.
- Pay attention to ventilation and heat dissipation when using the transformer. DO NOT place it on any fabric materials. DO NOT block cooling holes on the two sides with any things. DO NOT place it too close to other items, and keep at least 20mm distance.
- DO NOT place the transformer in any damp, dripping position. It should be stored in a ventilated and dry place.
- Cleaning: first unplug the power cord, and then clean the transformer with damp towel. Make sure no water drop into the transformer to avoid electric shock.
- DO NOT put any metal objects and debris into the transformer, so as to avoid short-circuit or electric shock. If any metal object falls into it inadvertently, stop using the transformer immediately, unplug the power cords, and mail UMIVC (umi-30@umpower.cn) for solutions.
- DO NOT open the bottom cover yourself, and non-professionals are not allowed to open the lid of the product.

## Function representation AV-250

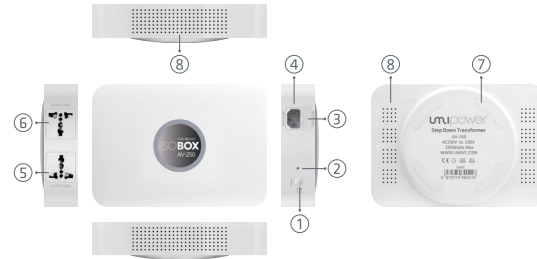

- Power switch: press in to turn on, press out to turn off.
- Power Indicator: turn on the power and indicator light.
- Input power fuse holder: Attention! Pull the power cord out of the power supply when replacing fuse. Use a small straight screwdriver to pry off the case and replace with same type fuse.
- input power socket
- output socket 1
- output socket 2  
Attention: Output socket 1 and 2 are in parallel.
- Transformer holder: Antiskid silica pad.
- Convection Heating-sinking holes are on the two sides, keeping ventilation and heat dissipation when using the product.

## Function representation AV-500 AV-1000

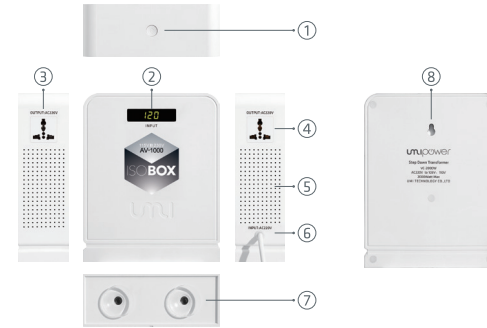

- Soft-touch power switch (press once to turn on, press again to turn off)
- Display input voltage: for example "220", which means the current grid voltage is 220V
- output socket 1
- output socket 2  
Attention: Output socket 1 and 2 are in parallel.
- Convection Heating-sinking holes are on the two sides, keeping ventilation and heat dissipation when using the product.
- Input three pole power cord
- Bottom sucker: fix the product to avoid to be knocked down (only available on a smooth surface).
- Wall hanging buckle hole: for using the transformer by hanging it on the wall.

## Parameters

	AV-250	AV-500	AV-1000
Rated Power	250VA	500VA	1000VA
Rated Current	2.1A/2.1A	4.2A/4.2A	8.5A/8.5A
input/output voltage	120V    120V		
Frequency	50/60Hz		
Temperature	-20°C - 40°C		
Transformer Type	Toroidal		
Efficiency	More than 95%		
Soft-start	No	Yes	
Bodyshell	PC+ABS Pastic		
Circuit Breaker with PTC	Yes		
Tube Fuse	F6AL 250V (20° Φ 5mm)	F10AL 250V (20° Φ 5mm)	F20AL 250V (20° Φ 5mm)
Protection Class	IP21		
Faraday electrostatic shielding	Yes		
Weight	2.9kg	4.7kg	7.2kg
Dimension	215mm X 153mm X 52mm	220mm X 175mm X 60mm	240mm X 185mm X 70mm

Note: There are four types per input / output voltage:  
230V || 230V 220V || 220V 120V || 120V 100V || 100V